

# VRCut<sup>+</sup> Ready TRIUMPH

VRCut software is bundled with these world renowned Triumph Cutters; known for their safety, power, precision, and ease of operation.



**Triumph 5260**  
Automatic clamp and IR safety light beam on front table.

Cutting width, inches	20-3/8
Cutting height, inches	3
Narrow cut, inches	1-3/8
Length behind blade, inches	20-3/8
Electrical	120V 20amp

5260



**Triumph 5560/5560 LT**  
Hydraulic blade, clamp drive, and IR safety light beam on front table. 5560 LT equipped with front and rear air tables (available by special order).

Cutting width, inches	21-5/8
Cutting height, inches	3-3/4
	(3-5/8 false clamp)
Narrow cut, inches	1-1/4
	(2-3/8 with false clamp)
Length behind blade, inches	22-7/16
Electrical	120V 20amp

5560



**Triumph 6660**  
Automatic clamp and IR safety light beam on front table.

Cutting width, inches	25-1/2
Cutting height, inches	3
Narrow cut, inches	1
Length behind blade, inches	24
Electrical	120V 20amp

6660



**Triumph 7260**  
Hydraulic clamp, 7" touch pad control module, and IR safety light beam on front table.

Cutting width, inches	28
Cutting height, inches	3
Narrow cut, inches	3/4
	(3-1/2 with false clamp)
Length behind blade, inches	28
Electrical	220V, 3 phase, 20amp

7260

# VRCut<sup>+</sup>

CUT WITH CONFIDENCE



A revolutionary tool to create and cut documents with ease on select Triumph cutters

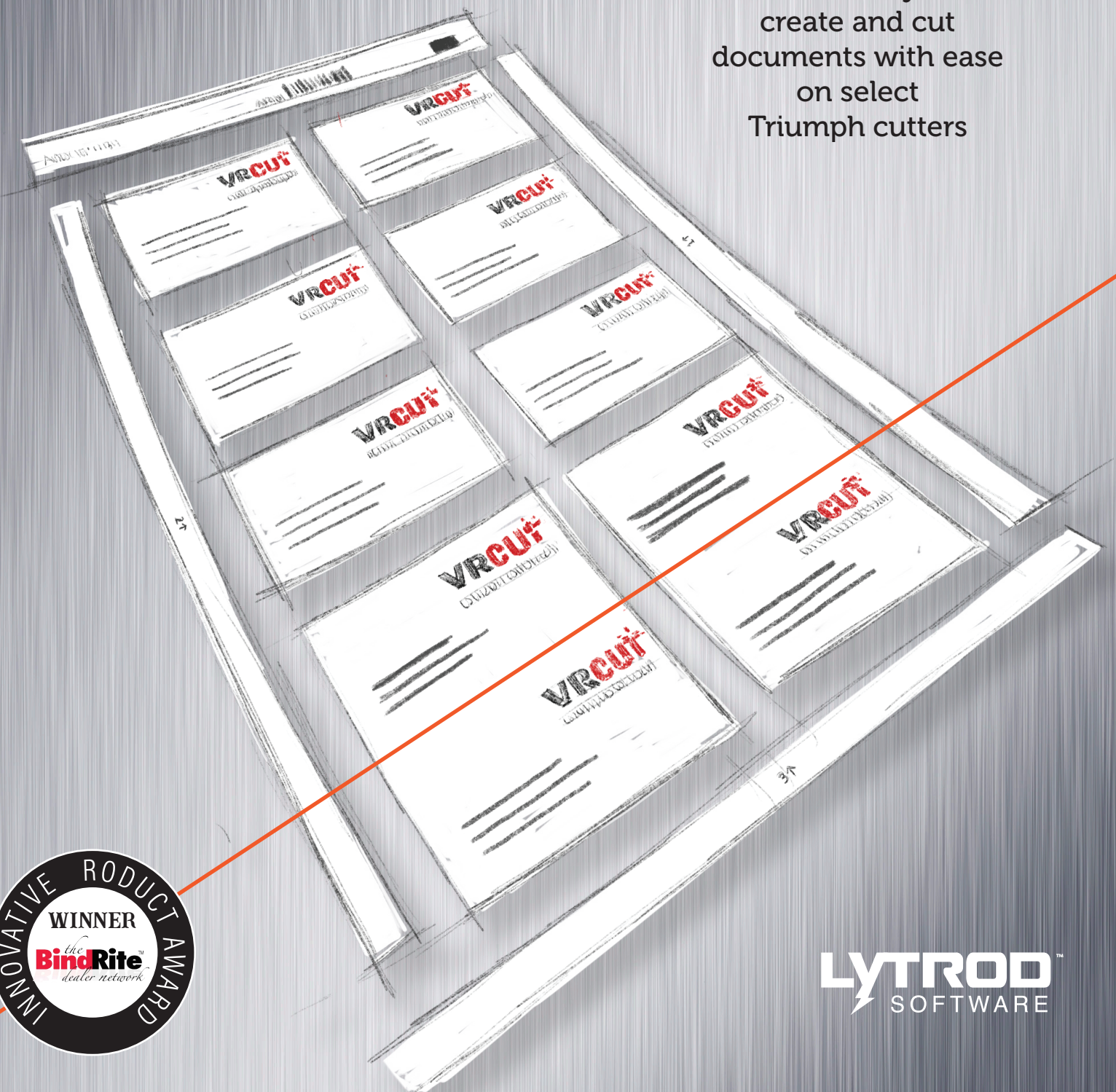

VRCut details

**Annual Licensing**  
1st year bundled with select Triumph cutters

**Internet Access**  
Activation, licensing & updates require internet access

**Hardware:**  
Operating System: Windows 7, 8, and 10  
Minimum Screen Resolution: 1440x900  
Cutter Connectivity: USB Port 2.0 or higher  
Optional: Barcode reader

**LYTROD<sup>+</sup> SOFTWARE**  
www.lytrod.com

**MBM CORPORATION**  
www.mbmcorp.com

©2018 Lytrod Software, Inc. All rights reserved. Unauthorized duplication is a violation of applicable law. Lytrod Software, the Lytrod logo and the VRCut logo are registered trademarks of Lytrod Software, Inc. MBM logo is a registered trademark of MBM corporation.



**LYTROD<sup>+</sup> SOFTWARE**



ACP0033

12x18 to 11x17 .125 bleed

# TWO MODULES, ONE INTEGRATED WORKFLOW

The VRCut solution consists of two independent modules that work together. The Impose module creates PDF documents formatted specifically to work with the VRCUT Controller module. The Controller module connects directly to the Triumph cutter moving the back gauge and visually guiding operators through the cutting sequence.

## CUT WITH CONFIDENCE

VRCut is a groundbreaking PC software solution designed to automate the cutting workflow by promoting an efficient and error-free cutting process from start to finish. VRCut intelligently bridges the gap between pre-press and the finishing process, allowing operators of any experience level the ability to cut with confidence on select Triumph cutters.

## VRCUT IMPOSE

The VRCut Impose module is a standalone PC imposition software that transforms your artwork into PDFs laid out specifically for optimized cutting on the VRCut enabled Triumph cutter. The software places a template barcode and innovative visual markers that enable an automated cutting process. Consolidate your workflows by taking advantage of the software's data merge feature.

Business card artwork is imposed into a PDF print file.



A barcode is automatically created that can be scanned for error-free job recall on the Triumph cutter.

As an additional guidance measure, cut sequence numbers and arrows are printed on the sheet to guide the operator.

## VRCUT CONTROLLER

The VRCut PC Controller module connects directly to your Triumph cutter for automatic back gauge movement and provides a step-by-step visual interface. The operator simply scans the document barcode to load the corresponding template and artwork to start the job. The software gives the operator visual indication of paper orientation, paper rotation between cuts, when to discard scraps, and how to process cut sheets. This first of its kind software simplifies the task of cutting, which allows operators with all levels of experience to **cut with confidence!**

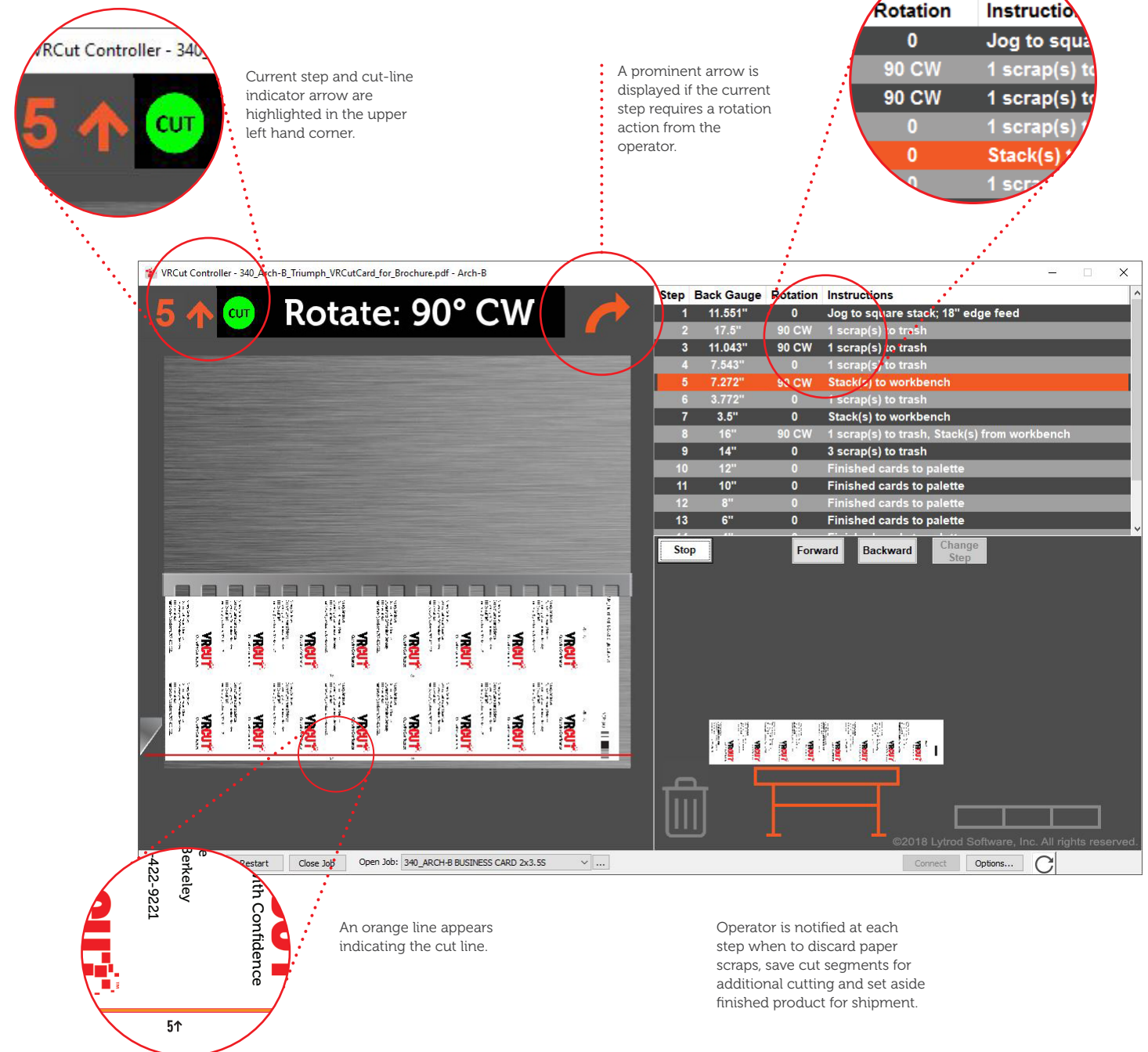

Current step and cut-line indicator arrow are highlighted in the upper left hand corner.

A prominent arrow is displayed if the current step requires a rotation action from the operator.

Full cut sequence instructions are displayed with the current step highlighted for quick reference.

Rotation	Instruction
0	Jog to square
90 CW	1 scrap(s) to trash
90 CW	1 scrap(s) to trash
0	1 scrap(s) to trash
0	Stack(s) to workbench
0	1 scrap(s) to trash

Step	Back Gauge	Rotation	Instructions
1	11.551"	0	Jog to square stack; 18" edge feed
2	17.5"	90 CW	1 scrap(s) to trash
3	11.043"	90 CW	1 scrap(s) to trash
4	7.543"	0	1 scrap(s) to trash
5	7.272"	90 CW	Stack(s) to workbench
6	3.772"	0	1 scrap(s) to trash
7	3.5"	0	Stack(s) to workbench
8	16"	90 CW	1 scrap(s) to trash, Stack(s) from workbench
9	14"	0	3 scrap(s) to trash
10	12"	0	Finished cards to palette
11	10"	0	Finished cards to palette
12	8"	0	Finished cards to palette
13	6"	0	Finished cards to palette

An orange line appears indicating the cut line.

Operator is notified at each step when to discard paper scraps, save cut segments for additional cutting and set aside finished product for shipment.